

VAJERGIVARE D125

D125.1000.RC11
Dragvajergiv.D125 10m CANopen

- Mätområde 6 till 10m
- Integrerad inklinometer
- Kan beställas med redundans
- IP67
- -40° till +85 °C



PRODUKTBESKRIVNING

TEKNISK DATA

Acceleration max	10 m/s
Hastighet max	1 m/s
Interface	CANopen DS301
IP-klass	IP67
Kontakter	M12-kontakt
Material Hus	Polykarbonat
Material Vajer	Rostfritt stål
Matningsspänning DC max	30 V DC
Matningsspänning DC min	9 V DC
Mätområde	0 - 100 000mm
Temperaturområde från	-40 °C
Temperaturområde till	85 °C
Upplösning	14 bit

Dimensions

Dimensions in mm (inch)

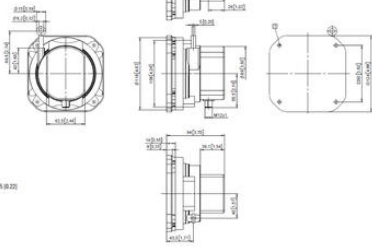

□ 44x19(20)

Terminal assignment

Sensor type	Type of connection	M12 connector, 5-pin					
AZ2, AA4, RZ2, R44 (analog sensor)	Signal	+V	h.c.	0V	Uout1	Uout2	
	Pin	1	2	3	4	5	
Sensor type	Type of connection	M12 connector, 5-pin					
R21 (CANopen)	Signal	0V	+V	CAN-GND	CAN-H	CAN-L	
	Pin	3	2	1	4	5	

+V: Power supply +V DC
 0V: Power supply GND (0V)
 Uout1: Voltage output 1
 Uout2: Voltage output 2

Top view of mating side, male contact base



M12 connector, 5-pin

Dimensions

Dimensions in mm (inch)

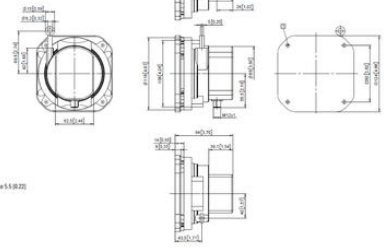

□ 44x19(20)